

REV.	SPECIFICATION	ECN NO.	APPD.

Material:

Contacts: Copper Alloy.

Terminal Plating: Tin plated.

Recommend Wire: 22 AWG To 30 AWG.

Inseulation OD: 1.60~1.13mm.

***RoHS Compliant**

T: Tin Plated 10K Pins Per Reel

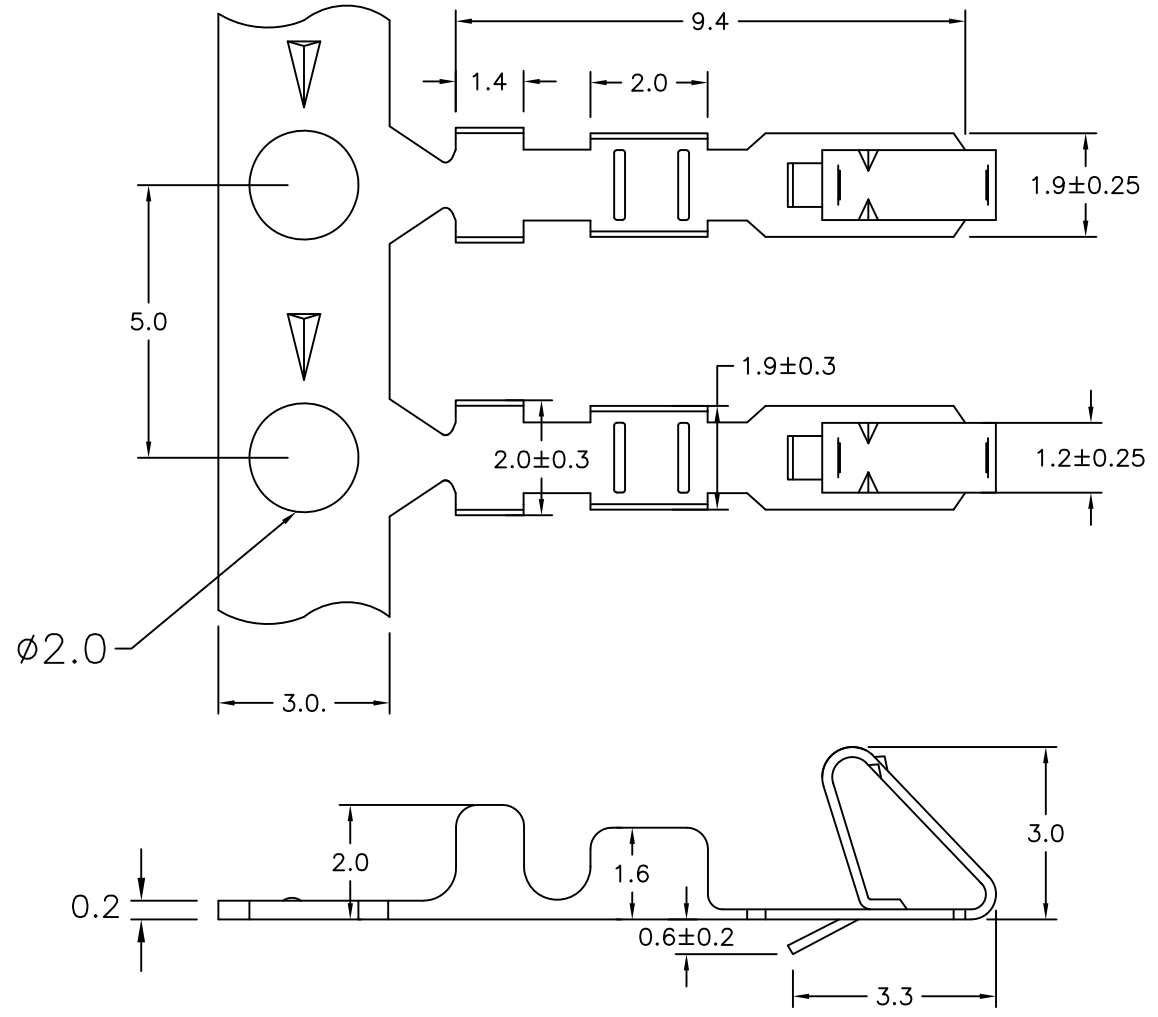

Tolerances	Dwg No.	4071P02001	
x = ± 0.5	Projection		
.x = ± 0.35	Unit	mm	Scale
.xx = ± 0.25	Drawn By	Vic Lyu10/20'15	

Title: 4071 Series Female-PIN

P/N: MCN-3101-0037			
SHEET	1/1	Ver.No.	A5

0704